

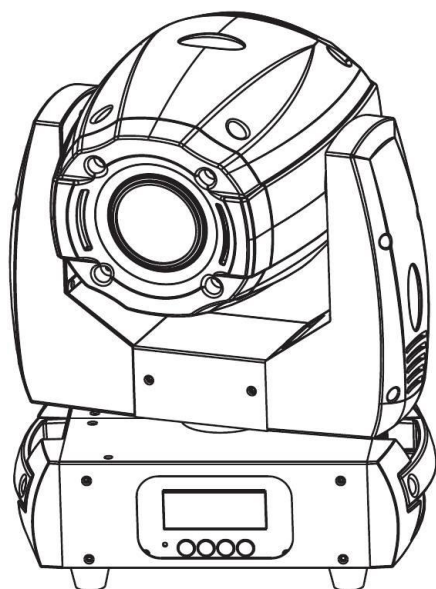

Minispot 150



KEEP THIS MANUAL FOR FUTURE NEEDS

1. GENERAL SAFETY INSTRUCTIONS

This device has left the GLG factory in perfect condition. In order to maintain this condition and to ensure a safe operation, it is absolutely necessary for the user to follow the safety instructions and warning notes written in this user manual.

If the device has been exposed to temperature changes due to environmental changes do not switch it on immediately. The arising condensation could damage the device.

Leave the device switched off until it has reached room temperature.

This device falls under protection-class 1. Therefore it is essential that the device be earthed. The electric connection must carry out by qualified person.

The device shall only be used with rate voltage and frequency.

Make sure that the available voltage is not higher than stated at the end of this manual Make sure the power cord is never crimped or damaged by sharp edges. If this would be the case, replacement of the cable must be done by an authorized dealer.

Always disconnect from the mains, when the device is not in use or before cleaning it. Only handle the power cord by the plug. Never pull out the plug by tugging the power cord.

During initial start-up some smoke or smell may arise. This is a normal process and does not necessarily mean that the device is defective, it should decrease gradually.

Please don't project the beam onto combustible substances. Fixtures cannot be installed on combustible substances, keep more than 50cm distance with wall for smooth airflow, so there should be no shelter for fans and ventilation for heat radiation.

If the external flexible cable or cord of this luminaire is damaged, it shall be exclusively replaced by the manufacturer or his service agent or a similar qualified person in order to avoid a hazard.

2. UNPACKING

Thank you for choosing our MINISPOT ML150. For your own safety, please read this manual before installing the device. This manual covers the important information on installation and applications. Please install and operate the fixture with following instructions. Meanwhile, please keep this manual well for future needs.

The MINISPOT ML150 is made of a new type of high temperature strength of engineering plastics and cast aluminum casing with nice outlook. The fixture is designed and manufactured strictly following CE standards, complying with international standard DMX512 protocol. It's available independently controlled and linkable with each other for operation. And it is applicable for large-scale live performances, theater, studio, nightclubs and discos.

The MINISPOT ML150 adopts a 150W white LEDlamp which features high brightness and stability. Please carefully unpack it when you receive the fixture and check whether it is damaged during the transportation. And please check whether the following items are included inside the box:

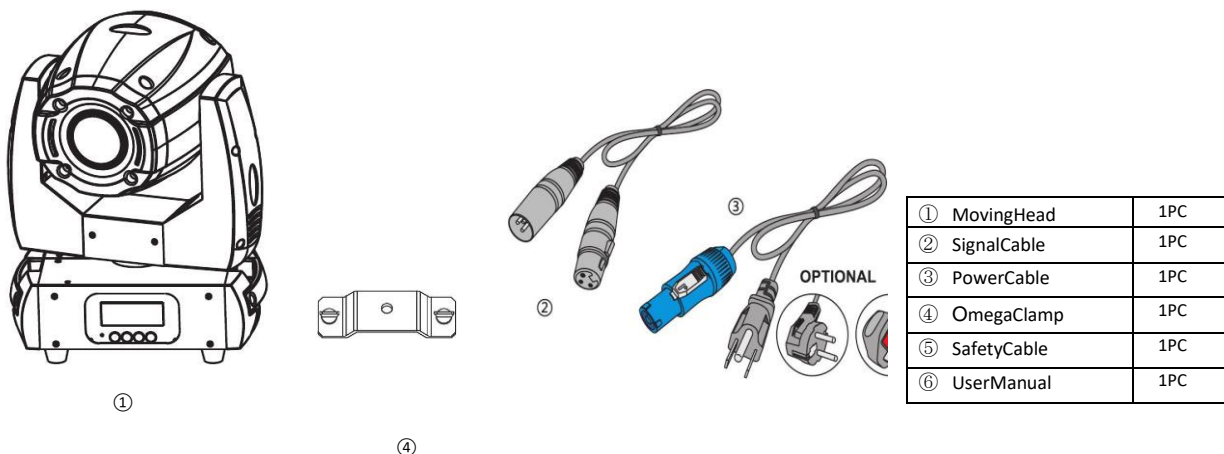

3. FEATURES

A 150W white LED lamp, 7.500K, 50.000 hours life span and low power consumption 8/16 bit smooth and precise resolution for PAN/TILT movement 360° / 540° / 630° PAN and 90° / 180° / 270° TILT movement PAN/TILT inversion available.

Scan position memory, auto reposition after unexpected movement

Specific high precision glass optic system with 13.2° projection angle. Improved optics and flat beam field

1 rotatable gobo wheel with 6 rotatable and interchangeable gobos plus open with speed, adjustable, stream effect, dithering effect and rotatable clockwise or anticlockwise.

Gobo size 23.9mm (external) / 15mm (inner)

Static gobo wheel with 11 gobos plus open

Frost filter

Color wheel with 7 colors plus open

Variable direction rainbow effect with speed adjustable.

2 meter to infinite electric focus

6-facet prism with variable speed and direction

0-100% smooth linear LED dimmer

Preset variable/random strobe and dimming pulse effect 25T/sec high speed LED shutter/strobe effect with variable speed

14/12/16 DMX channels USITT DMX-512

DMX512, master-slave, and sound activated controllable or auto operation (7 built-in programs)

DMX recorder and edit function integrated

Blue LCD display

POWERCON connector IN/OUT, 3-pin XLR connector IN/OUT

Constant temperature readout and management function

45° Cmax ambient temperature

IP20 protection rating

55dB at 3'dB rating

1· 1/4 turn fastening Omega clamp

1* Safety attachment point

16B	8B	DE			
1	1	1	Pan	0-255	PAN movement
2		2	Pan-fine	0-255	Fine control of Pan movement
3	2	3	Tilt	0-255	Tilt movement
4		4	Tilt-fine	0-255	Fine control of Tilt movement
5	3	5	Color Wheel	0-15	Open/white
				16-31	Color1
				32-47	Color2
				48-63	Color3
				64-79	Color4
				80-95	Color5
				96-111	Color6
				112-127	Color7
				128-189	Forwards rainbow effect from fast to slow
				190-193	Color rotation stop
				194-255	Backwards rainbow effect from slow to fast
6	4	6	Gobo wheel 1	0-g	Open
				10-19	gobo1
				20-29	gobo2
				30-39	gobo3
				40-49	gobo4
				50-59	gobo5
				60-69	gobo6
				70-89	Gobo1 shake slow to fast
				90-109	Gobo2 shake slow to fast
				110-129	Gobo3 shake slow to fast
				130-149	Gobo4 shake slow to fast
				150-169	Gobo5 shake slow to fast
				170-189	Gobo6 shake slow to fast
				190-255	Rot. gobo wheel cont. rotation slow to fast
7	5	7	Gobo1 Rotation	0-3	No function
				4-127	Forwards gobo rotation from fast to slow
				128-131	Gobo rotation stop
				132-255	Backwards gobo rotation from slow to fast
8	6	8	Gobo wheel 2	0-g	Open
				10-19	gobo1
				20-29	gobo2
				30-39	gobo3
				40-49	gobo4

4. CHANNELS

				50-59	gobo5
				60-69	gobo6
				70-79	gobo7
				80-89	gobo8
				90-99	gobo9
				100-109	gobo10
				110-119	gobo11

				120-129	Gobo1 shake slow to fast
85-87			Scan motor reset	130-139	Gobo2 shake slow to fast
88-90			Colors motor reset	140-149	Gobo3 shake slow to fast
91-93			Gobo motor reset	150-159	Gobo4 shake slow to fast
94-96			Shutter & Dimmer motor reset	160-169	Gobo5 shake slow to fast
97-99			Other motor reset	170-179	Gobo6 shake slow to fast
				180-189	Gobo7 shake slow to fast
100-119			Internal program1	190-199	Gobo8 shake slow to fast
120-139			Internal program2	200-209	Gobo9 shake slow to fast
140-159			Internal program3	210-219	Gobo10 shake slow to fast
				220-229	Gobo11 shake slow to fast
				230-255	Rot. gobo wheel cont. rotation slow to fast
9	7	9	Shutter	0-31	Shutter closed
				32-63	shutter open
				64-95	Strobe effect slow to fast
				96-127	shutter open
				128-159	Pulse-effect in sequences slow to fast
				160-191	shutter open
				192-223	Random strobe effect slow to fast
				224-255	shutter open
10	8	10	Dimmer	0-255	Dimmer 0%-100%
11	9	11	Focus	0-255	Ln (near) to out(far)
12	10	12	Rotating	0-5	OFF
				6-127	ON
			prism,	128-189	Forwards rotation from fast to slow
			Prism rotation	190-193	Prism rotation stop
				194-255	Forwards rotation from fast to slow
13	11	13	Speed	0-225	Max to min speed
				226-235	Blackout by movement
			pan/tilt	236-245	Blackout by all wheel changing
				246-255	No function
14	12	14	Special	0-1g	No function
				20-29	No function
				30-39	Gobo Change to any position
				40-79	No function
			function	80-84	All Motor reset

160-179	Internal program4
180-199	Internal program5
200-219	Internal program6
220-239	Internal program7
240-255	Internal Sound program1

Vector Mode			Function	Values	Description
		15	Color Time	0-255	Max to min speed
		16	Gobo Time	0-255	Max to min speed

5. MENU OPTIONS

DMX Address	A001-AXXX			DMX address setting
Auto Play	Auto Program	Master/Alone		Auto Program
	Music Control	Master/Alone		Music Control
Reset	ALL Reset	On/Off		ALL Reset
	Scan Reset	On/Off		Scan Reset
	Color Reset	On/Off		Color Reset
	GOBO Reset	On/Off		GOBO Reset
	Dimmer Reset	On/Off		Strobe & Dimmer Reset
	Other Reset	On/Off		Other Reset
Reverse Pan	On/Off			Reverse Pan
Reverse Tilt	On/Off			Reverse Tilt
Mic sensitivity	0-99%			Sensitivity of mic
Special	Reset Default	On/Off		Reset Default
	Calibration	Code(Password:008)		Calibration Code
		PAN. TILT, Color Wheel, Gobo Wheel 1, Gobo Wheel 2. Focus, Pri1		Calibration of the channel
	Temperature	XXX°C/°F		Current Temperature
	Manual Control	PAN=XXX_ _		Manual Control
Signal Set	Wire DMX		Wire DMX	
	Wireless DMX		Wireless DMX	
	Act WDMX& Out		Act WDMX& Out	
Edit Program	Auto	Steps(1 _48)		Set Number of scenarios
	Program1	Scenes 01	Pan=XXX_	Set the scenes channel
	Program8	Scenes XX	Time=xx.xS	Value & scenes times
Mode of channel	Standard Mode			Standard Mode
	Basic Mode			Basic Mode
	Extended Mode			Extended Mode
Select Degree	PAN Degree	630°/540°/360°		Pan Degree, default is 540°
	TILT Degree	270°/180°/90°		Tilt Degree, default is 270°
Version	V1 0-V9.9			software Version

6. PHOTOMETRIC DATA

Photometric Beam Angle Data 3.2° Beam Angle= -xx 0.0929=Fc

2302/24790 573/6170 280/3020 177/1910

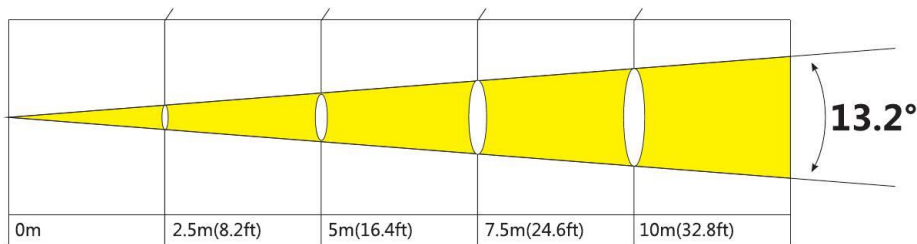

7. INSTALLATION

Cautions: For added protection mount the fixtures in areas outside walking paths, seating areas, or in areas where the fixture might be reached by unauthorized personnel.

Before mounting the fixture to any surface, make sure that the installation area can hold a minimum pointload of 10 times the device's weight.

Fixture installation must always be secured with a secondary safety attachment, such as an appropriate safety cable.

Never stand directly below the device when mounting, removing, or servicing the fixture.

from a ceiling, or set on a flat level surface (see illustration below). Be sure this fixture is kept at least 0.5m (1.5 ft) away from any flammable materials (decoration etc.).

Always use and install the supplied safety cable as a safety measure to prevent accidental damage and/or injury in the event the clamp fails.

Mounting points: Overhead mounting requires extensive experience, including amongst others calculating workingload limits, a fine knowledge of the installation, material being used, and periodic safety inspection of all installation material and the fixture. If you lack these qualifications, do not attempt the installation yourself.

Improper installation can result in body injury!!

Be sure to complete all rigging and installation procedures before connecting the main power cord to the appropriate wall outlet

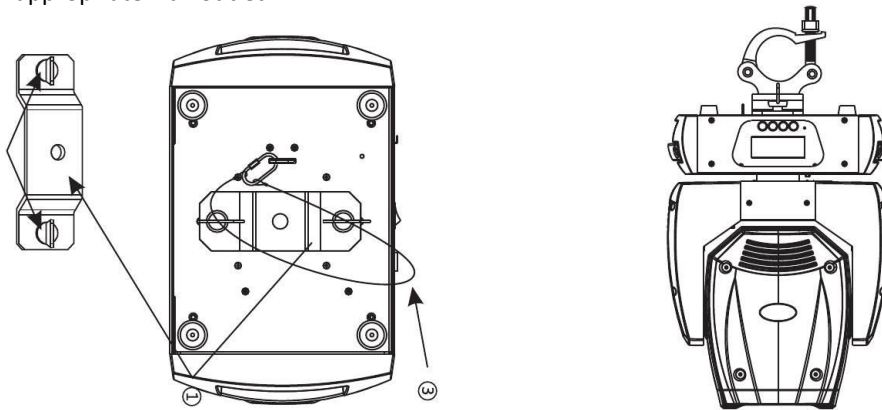

Clamp Mounting: The MINISPOT ML150 provides two unique mounting bracket assembly's that integrates the bottom of the base, the included "Omega Bracket" and the safety cable rigging point in one unit (see the illustration below). When mounting this fixture to truss be sure to secure an appropriately rated clamp to the included omega bracket using a M10 screw fitted through the center hole of the omega bracket). As an added safety measure be sure to attached atleast one properly rated safety cable to the fixture using on of the safety cable rigging point integrated in the base assembly.

Regardless of the rigging option you choose for your MINISPOT ML150, always be sure to secure your fixture with a safety cable. The fixture provides a built-in rigging point for a safety cable on the hanging bracket as illustrated above. Be sure to only use the designated rigging point for the safety cable and never secure a safety cable to a carrying handle.

8. DMX 512 CONNECTIONS

Connect the provided XLR cable to the female 3-pin XLR output of your controller and the other side to the male 3-pin XLR input of the moving head. You can chain multiple Moving head together through serial linking. The cable needed should be two core, screened cable with XLR input and output connectors. Please refer to the diagram below.



DMX-Pinning

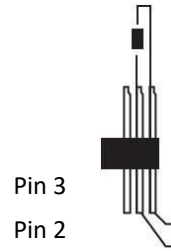

DMX-512 connection with DMX terminator (120 Ohms)

For installations where the DMX cable has to run along distance or is in an electrically noisy environment, such as in a discotheque, it is recommended to use a DMX terminator. This helps in preventing corruption of the digital control signal by electrical noise. The DMX terminator is simply an XLR plug with a 120 Ohm resistor connected between pins 2 and 3, which is then plugged into the output XLR socket of the last fixture in the chain. Please see illustrations above.

9. Specifications

Input Voltage:	AC 90-260V 50/60Hz
LED Quantities:	1 x 150W white LED
Control Signal:	DMX512, master-slave and sound activated or auto operation 14/12/16
Control Channel:	DMX channels USITT DMX-512
Power Consumption:	175W
Dimensions:	183(D) x 298(W) x 410(H)mm
Packing Dimensions:	270(D) x 370(W) x 590(H)mm
Net Weight:	9.5 kg
Gross Weight:	11 kg

